

# Triangle Display Rack

## Assembly Instructions

1. Triangle Table Top
2. Triangle Table Base
3. Triangle Racks (x3)
4. Table Poles (x3)
5. Rack Poles (x6)

6. Graphic
7. Screws

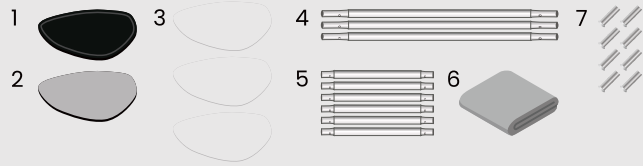

### 1 Assemble the Frame

Place bottom frame flat on the floor and insert the poles into each of the holes. Connect all of the poles together by matching each number to its counterpart.

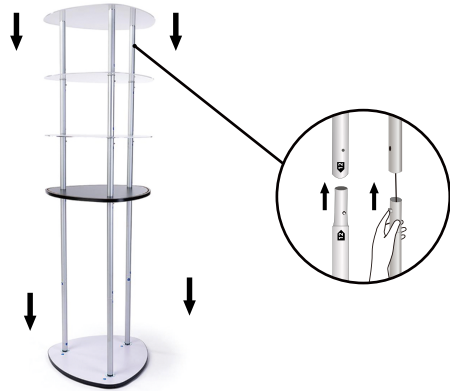

### 2 Assemble the Frame

Tighten everything

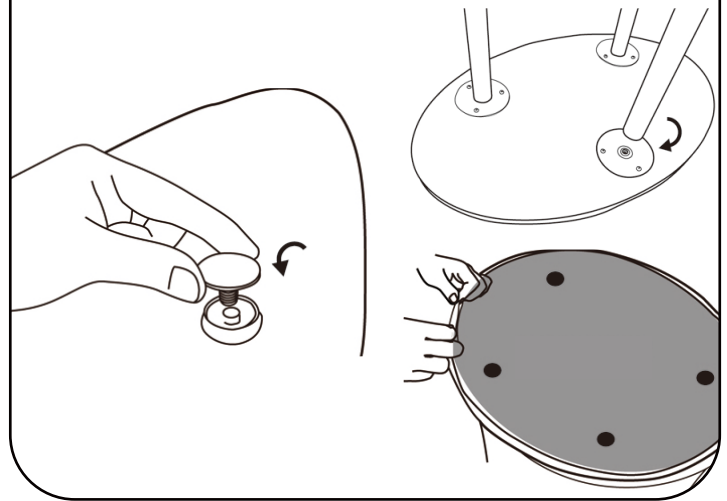

### 3 Install the Graphics

Carefully pull the graphic print over the frame and zip up

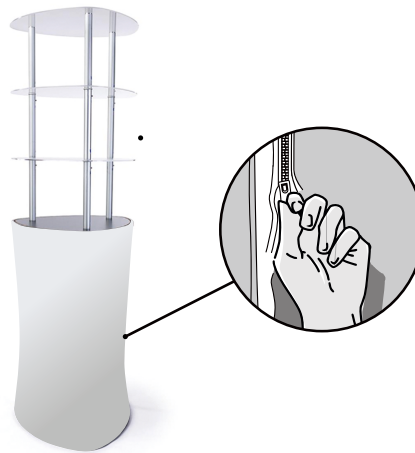

### Storage & Care:

Store in a cool dry location. Clean hardware with a damp cloth. Machine wash the graphics in cold water on a gently cycle. Air dry only. Use a steamer for wrinkles. Never dry-clean.